



## **WAN Education Award 2016**

### Contents:

- 1 Winner Press Release
- 2 Shortlisted Press Release
- 3 Jury Panel
- 4 Background to WAN and the WAN AWARDS

## 1. Winner Press Release

### WAN Education Award 2016 Winner Announced

#### JJW Architects triumphs with South Harbour School project to claim title

We are thrilled to announce JJW Architects as the winner of the WAN Education Award 2016 for their highly articulated project, South Harbour School – Congratulations!

The winner was selected from a shortlist of six high calibre projects that showcased a remarkable and diverse range of the best in international educational design. We were honoured to have a fantastic line up of judges for this award, who had the responsibility of picking a winner. The panel included: Simon Allford Director at Allford Hall Monaghan Morris, Sarah Ball Principal at Woods Bagot, Maria Nesdale Education & Culture Practice Area Leader, Senior Associate at Gensler, Keith Papa Architect Director at Building Design Partnership (BDP) and Keith Lilley Director of Estates & Facilities Management at Sheffield University.

Located in Copenhagen, Denmark where the population is currently growing at a fast pace of over 1,000 new citizens a month, the city needed to look at increasing its school facilities. South Harbour School is a new public school with a maritime and public profile, inviting in its neighbours and reaching out to its city, becoming an active and socially sustainable part of its new community. In due time the public will also gain access to classrooms dedicated to specific subjects such as music and cooking classes. Simon expressed his views, saying, “By far the best of the highly articulated schemes, this project engages the landscape and the building in making a new place, in a new piece of city.”

JJW Architects designed South Harbour with the understanding that schools are equally places for the learning process and also for social exchange. Surprises and new experiences are central concepts for the school. On each floor, plans change and the heights of the rooms vary throughout. These scale changes are central to the project where high ceiling open rooms are combined with more intimate, low-ceiling spaces. The school also features a variety of horizontal and vertical connections and spaces. The idea behind this design is to ensure students, teachers and visitors are surprised, challenged and stimulated as they move around indoors and outdoors. The dualities of activity/rest, light/dark, warm/chilly are all part of the concept. South Harbour School provides different spaces and environments to support the children’s learning processes and social abilities. The jury members were unanimously impressed by the use of space. Sarah remarked, “When you look at it, absolutely every single space is being used. I also love how this sits, it’s completely contextual and it has its own identity.” Keith P followed on to say, “I think that the kids would definitely love it, no doubt about it. It’s been done with a really rigorous and intelligent plan that is not in any way wilful, which is incredible. It’s a really clever and wonderful piece of architecture.”

The school also uses a number of technical solutions to aid in creating a good indoor and acoustically controlled environment, keeping the energy consumption at a minimum level. Various studies show that good use of acoustics have a positive impact on the student learning process and wellbeing, therefore acoustics have been one of the major focus areas throughout the project.

Final comments on this project came from Maria who simply said, “This is just so Danish and clever, it’s playful, it’s happy and it looks like a happy space to be. Which I think we can all agree on, schools are meant to be our happiest days after all!”

Congratulations to JJW Architects, South Harbour School a truly worthy winner.

WAN AWARDS would like to thank all of this year’s jury panel and all those who entered into the Education Award 2016. Moving into its eighth year, this popular category continues to showcase the best in educational design.

Christina Ingram

Awards Co-ordinator



South Harbour School by JJW Architects © Torben Eskerod

## 2 Shortlisted Press Release

### WAN Education Award 2016 Shortlist Announced

#### Six remarkable and diverse projects showcase the best in educational design

Rolling into its eighth year the WAN Education Award 2016 is one of WAN AWARDS longest standing categories. This ever popular award is the largest of its kind attracting entries from across the globe. It celebrates the best in design for all levels of educational and research use, from nurseries, primary and secondary schools, through to universities, research facilities and training academies.

The 34 longlisted projects were recently reviewed by a jury panel of leading experts who assessed these for originality, innovation, form, function, sustainability and context. The jury also took into account how these longlisted designs addressed the client brief and how the design was used to evolve or push the boundaries of this typology while looking for examples of how the building enhanced the learning environment.

This year's esteemed jury panel were: Simon Allford Director at Allford Hall Monaghan Morris, Sarah Ball Principal at Woods Bagot, Maria Nesdale Education & Culture Practice Area Leader, Senior Associate at Gensler, Keith Papa Architect Director at Building Design Partnership (BDP) and Keith Lilley Director of Estates & Facilities Management at Sheffield University.

The five jury members selected a shortlist of six and one commended project which are as follows, in no particular order:

#### D1 Kindergarten and Nursery in Japan by HIBINOSEKKEI + Youji no Shiro

This pared back design from Kumamoto, Japan had the jury in immediate discussion. This kindergarten by city style had been requested to provide a variety of educational programs due to the sensitivity of parent's requests. The brief also required to provide a highly changeable plan where fixed items are not set, as much as possible within the building.

Simon recognised the simplicity of this project stating, "A very simple but beautifully executed idea for a kindergarten. The building can open up and close the environment and is endlessly flexible. It is also memorable and stands out for the fact that it combines a powerful idea of change with an important idea of character and place making." Maria reflected Simon's comments with: "It's just pared back and incredibly Zen. I think it's designed to be a blank canvas exactly to interchange, and the kids become the activity, the fun and the playfulness, they make the building what they like it to be."

#### Bilkent Erzurum Laboratory School in Turkey by FXFOWLE

Founded by Bilkent University, Ankara, BELS's altruistic mission is to provide a world-class, international education to the most promising children in one of the country's most isolated and impoverished regions - free of charge.

Two-stories high, the school's upper ribbon turns uphill to meet the gradient, forming a central green for the campus to one side which is used for ice skating in the winter, and a wind-protected entrance and play area to the other. This wing houses the upper elementary program and the library. A large, double-height cafeteria connects the schools together, serving as its community living room throughout the day. Awash in daylight, this space frames sweeping views of the majestic Palandöken Mountain range on all sides. Sarah was first to put her comments forward saying "The views are beautiful. I think that they have really played to the context here with the views and the experience that the children will have in the classrooms. They have been thinking about how the children experience it. I like it." Maria also followed on to say, "The idea of this project is lovely, the fact that they are building a school for a very remote, impoverished community, for free, and that the quality of this is really high. I think that this project has really fantastic intentions."

#### Arcus Center for Social Justice Leadership USA by Studio Gang Architects

This centre for social justice is in Kalamazoo and located adjacent to three disparate settings: a residential neighbourhood; the traditional, colonial campus architecture; and a grove of hardwood trees. Kalamazoo College wanted to ensure that the new building would harmonize with its surroundings. The building responds to this context with welcoming transparent facades that are connected by gently arcing exterior walls. The jury warmed to this design instantly, commenting on the quality of the presentation. Sarah exclaimed, "Wow! Beautiful! This could have been quite internalised, but what they have done really well here is that not only is it all looking out, but everyone can also see in."

The walls, are made of locally sourced, naturally insect-resistant Northern White Cedar set as masonry, which establishes common ground between the differing neighbourhood and campus architectures and the natural landscape, while also setting a new, distinctive tone for sustainability. Maria praised the project saying, "It's not your usual student building or classroom, it's a

place for promoting discussion about social injustice, and it's where people can come together and discuss the world's problems which is very inspirational." Keith L simply stated, "I think that this is a really beautiful building, I can really see the beauty of this project."

#### SOUTH HARBOUR SCHOOL in Denmark by JJW Architects

With Copenhagen growing at a fast pace and there being over 1,000 new citizens a month, the city is in need of expanding its school facilities - that was the starting point for the South Harbour School project. Furthermore the Municipality wanted a new school that is an active part of the new neighbourhood in a former industrial area that is currently undergoing a transition. The result is South Harbour School: a new public school with a maritime and science profile.

Central to the design is the understanding of schools as places for learning processes as well as social exchange. The ground floor is the school's natural meeting place, and is developed as a mixture between an aula and a city square. The public has access to intriguing outdoor areas that enhance movement and play. The concept of the social space addresses everything from the overall school community over group assemblies to one to one meetings between classmates.

Maria appreciated the Danish approach to education saying "It's a very personalised approach to learning, incredibly personalised, where everybody's responsible for their own learning whatever age, but then allowing the building to support that in that kind of incidental way." Keith L followed on by saying, "I just think that the people who are going to be in this space, will love the space."

#### Austin Community College Highland Campus in the USA by Barnes Gromatzky Kosarek Architects

The Austin Community College located in Texas was in need of temporary space so as to accommodate students and faculty while expanding and renovating its many existing campuses. Austin Community College began investigating into the possibility of acquiring portions of a declining shopping mall. Rather than purchase a large undeveloped property in an outer location, Austin Community College opted instead for this rather bold and unconventional alternative. Maria spoke avidly saying, "Ah so it's a shopping mall that's been converted into a community college? That's cool! Knowing the context and background of what these community colleges are facing, I think that it's a very innovative approach. The whole social context behind this is it's giving a lot of people, a lot of opportunity they would just not have. It's a contextual response to a very difficult problem, both socially, educationally and architecturally."

The transformation of this site into a state-of-the-art academic facility sets a national example for the sustainable repurposing of undervalued civic assets. Keith L was receptive to this project saying, "I think it's great, I think it's absolutely great." Agreeing with Maria, Keith L went on to say, "These are the issues you face, I mean look what they've done! They've made an ugly building into something that is very attractive." Simon also confirmed with, "A very tough reuse project, this successfully turns a powerful, enclosed brutalist box into a "field" for learning."

#### Chipakata Children's Academy Zambia by Ennead Architects

Located in Zambia Africa, the Chipakata Children's Academy is the first initiative for the 14+ Foundation, a New York City-based non-profit organisation established in 2012. The design for the new school realises the Foundation's mission to develop, build and operate schools and orphanages in rural African communities. Locating the school within the village has dramatically reduced the distance the children must walk to school each day, as the nearest school is seven kilometres away.

The Academy provides a comprehensive primary school education, grades 1-7, for children in seven villages in and around the Chipakata Village community. Sarah shared her views on this brilliant project saying, "I like this is due to the community impact, where they have built this in an area where the locals didn't believe a school was possible, and that this could be achieved. They also established a training programme to teach the locals the skills to help build it. It's very contextual and it's addressed the elements of the brief." Keith P also commented, "What it's actually done as a project in itself is quite amazing, because they have built it themselves, it is an unusual broach for their area. When you look at what has been achieved and the rationality on it, it's really quite brilliant."

On top of the final six shortlisted projects, the judges also wanted to commend Galaxy Elementary School in the USA by Zyscovich Architects which was recognised by the jury for its use of space and planning. Keith L revealed, "The thing that's really nice for me is that there's lots of learning spaces and you get the sense that the kids are encouraged by the space. For me this is more about the educational experience." Maria also added, "What I like about this is the way that they have inserted and integrated learning throughout the building is really clever. In terms of its curriculum and how it's being used it's brilliant, and using the building as a learning tool. I really commend that."

Congratulations to all those shortlisted and a big thank you to all those who entered into this year's WAN Education Award 2016. The final winner will be announced on April 26.

Christina Ingram  
Awards Co-ordinator





Chipakata Children's Academy by Susan T. Rodriguez (Ennead Architects), Frank Lupo, Randy Antonia Lott 2016 ©Rob Duker for Joseph Mizzi





Austin Community College Highland Campus by Barnes Gromatzky Kosarek Architects





Bilkent Erzurum Laboratory School by FXFOWLE Architects ©Thomas Mayer



D1 Kindergarten and Nursery by HIBINOSEKKEI + Youji no Shiro © Studio Bauhaus Ryuji Inoue



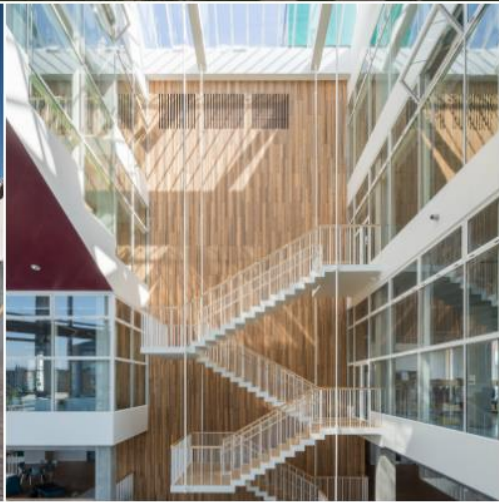

South Harbour School by JJW Architects © Torben Eskerod





Arcus Center for Social Justice Leadership by Studio Gang Architects © Steve Hall © Hedrich Blessing





Galaxy Elementary School by Zyscovich Architects © Miami in Focus

### 3 Jury Panel

#### **Simon Allford - Director, Allford Hall Monaghan Morris**

From Allford Hall Monaghan Morris' base in Clerkenwell Simon leads a studio that works in London and internationally, engaging public and private clients in the exploration of a particular architecture's potential to offer delight as well as utility.

Simon works on a wide range of scales and typologies. Notable recently completed projects include 61 Oxford Street, 240 Blackfriars Road, Chobham Academy in the Olympic village (where he also advised on the masterplan), the Angel, Tea and Yellow Buildings, the Saatchi and 176 Galleries, Adelaide Wharf, various research, amenity and academic buildings in Alconbury as well as student housing schemes at Camley a Street and Westminster Bridge Road. He is currently working on major regeneration projects including The Bower & The White Collar Factory on Old Street roundabout, Notting Dale Village and Hawley Wharf in Camden. Other major building projects on site include offices for Google; the theatre, public space, retail and office buildings at No 1 Oxford Street; The mixed use Post Building in Bloomsbury; four major mixed use projects on Regent Street for the Crown Estate and at Rooterseiland Amsterdam the campus and major academic building for the UvA. Simon also leads AHMM's large urban scale projects in the USA.

Simon is Chairman of the Architecture Foundation, a trustee of the Architecture Association Foundation, and a visiting professor at The Bartlett, UCL and GSD Harvard. He has taught, lectured and examined at many schools and was recently Vice President for Education at the RIBA and a Chair of Design Review at CABE. Simon engages in the broader architectural discussion as a frequent writer, critic, teacher, competition juror, frequent lecturer, examiner, advisor and commentator.

#### **Sarah Ball - Woods Bagot**

Sarah leads Woods Bagot's Global Education Sector. Her passion and leadership is exemplified by an extensive architectural and interior design portfolio of successful and innovative projects in Australia, UK and USA, including the Deakin University Burwood Highway Frontage Building, The University of Melbourne School of Engineering Student Learning Centre, Swinburne University Knox Innovation Opportunity & Sustainability Centre and the Marriot Student Learning Centre at Cornell University. Many of her projects have been acknowledged with education and design industry awards. With broad experience across a range of School and University environments, Sarah has amassed significant knowledge of pedagogy, next generation learning spaces and technology underpinned by her commitment to research. Sarah is particularly interested in how the design of space can enhance the student teaching and learning experience on Campus.

#### **Keith Lilley - University of Sheffield, Director of Estates and Facilities Management**

Keith Lilley started his career with the NHS as a management trainee, initially based in Yorkshire before moving to Guys and Lewisham NHS Trust in 1988.

In 1999, Keith joined the newly established Leeds Teaching Hospitals NHS Trust as Director of Facilities. Six years later, Keith joined the University of York as Director of Facilities, as it began the major expansion of its campus, with an initial development of around 65,000m<sup>2</sup> of new buildings on a 58 hectare site.

In September 2010, Keith took up the role of Director of Estates and Facilities Management at the University of Sheffield. The University has embarked on ambitious plans to improve and develop its city centre campus, as well as a major expansion of its Advanced Manufacturing Research Centres close to the M1 corridor. The University is delivering significant investment in Engineering with the centrepiece being the 20,000m<sup>2</sup> Diamond at the heart of the campus, which opened in September 2015.

Keith is totally enthused by the opportunity of contributing to the success of one of the UK's leading HE institutions, and directing significant investment in his adopted home city.

#### **Maria Nesdale – Education & Culture Practice Area Leader, Senior Associate, Gensler**

As a Firmwide Leader of our Education & Culture Practice, Maria guides teams in designing enhanced educational environments that deliver a vastly enhanced learning experience for students of all levels. She also serves as the Regional Leader of the Education & Culture Practice Area based in London. A Senior Associate and Registered Architect, Maria is highly regarded as a specialist in her field. She was invited to participate on the *World Architecture News* awards jury panel for education in 2012 and



the *World Architecture News* Effectiveness Awards in 2013. She earned a B.A. Hons in Architecture at the University of Portsmouth and a Diploma in Architecture at the University of Westminster, where she also pursued Postgraduate Certificate Professional Practice in Architecture.

**Keith Papa - Architect director, Building Design Partnership (BDP)**

Keith specialises in design for education, most recently with a focus on the briefing, design and delivery of science research buildings, espousing collaborative working.

He has also been responsible for some of our most innovative school designs, including the award-winning Marlowe Academy and Bridge Academy.

He is passionate about raising the aspirations of clients, end-users and other stakeholders, to demand more of places designed for learning.

#### 4. Background to WAN and the WAN AWARDS

World Architecture News (WAN) launched in 2005 and is now the world's leading supplier of news to the global architectural community. In 2007, WAN reached the prestigious Google no.1 position for architecture news and has remained in pole position since.

In addition to being an unparalleled source of news for developers, organisations, consultants, students and architects in over 120 countries, the WAN AWARDS are today highly recognised and regarded worldwide, in an industry where competitions and awards have always been an intrinsic element of winning new work for architects.

The value of an award is determined not only by the quality of the jury panel but also by the number and calibre of participants. Using their exclusive WAN database and contacts around the world, WAN are able to pull together an unprecedented fusion of high quality architecture and internationally acclaimed judges drawn from both top architectural practices and experts from each sector. 2013 saw the level of entries rise to over 1500 outstanding projects, making the WAN AWARDS the largest architectural awards programme worldwide.

Now in its eighth year, the WAN AWARDS aims to celebrate the best in architectural design. As the largest award of its kind, attracting entries from all over the world, the award offers an unparalleled opportunity to gain recognition and exposure for your work.

For any further information please contact: [awards@builtenvironmentmedia.com](mailto:awards@builtenvironmentmedia.com)